

Measure MM Projects – Community Learning Center

MiraCosta’s Community Learning Center (CLC) is located in downtown Oceanside. This 7.6-acre urban facility is home to the college’s noncredit courses. The CLC is located just east of Interstate 5 at the Mission Avenue exit, and is easily accessed by public transportation.

The Facilities Master Plan for the CLC looks to create a cohesive environment that feels like other MiraCosta campuses. This is accomplished through the creation of a centralized campus quad that provides the physical elements that comprise a college campus. Active outdoor areas will knit together the instructional spaces with the new student-centered building. The quad will allow students to stay on campus for longer periods of time by providing much needed study and socialization spaces and improving the campus aesthetics. All these elements work together to increase the student experience on campus, thus increasing the overall student success at the CLC.

The new Student Resources Building will provide an anchor for the new campus quad that will encourage students to interact with the outdoor environments. It will provide the space to correct the space deficiencies in office, library, and instructional media spaces.

View the Facilities Master Plan at www.miracosta.edu/masterplan.



Current Community Learning Center site



Measure MM Projects – Community Learning Center – Phase I

NEW CONSTRUCTION

The new Student Services Building provides the flexibility to become a student-friendly space that consolidates the study and social spaces into a Student Services Center - a single, dynamic environment provides the staff spaces required to properly serve the needs of the CLC.

The project will include an events terrace, a park and native garden, and a series of bioswale – shallow, open and typically vegetated channels with gently sloping sides that can be incorporated into landscapes to direct and slow storm runoff and promote pollutant removal.

The preliminary programming and space planning for the building includes:

- Preliminary Building Area - 5,550 Assignable Square Feet (ASF)
- Total ASF – 5,550 ASF
- Total Gross Square Feet (GSF) - 9,270 GSF

Project Timeframe:

- Design Start: March 2018
- Construction Start: September 2019
- Construction Completion: October 2020

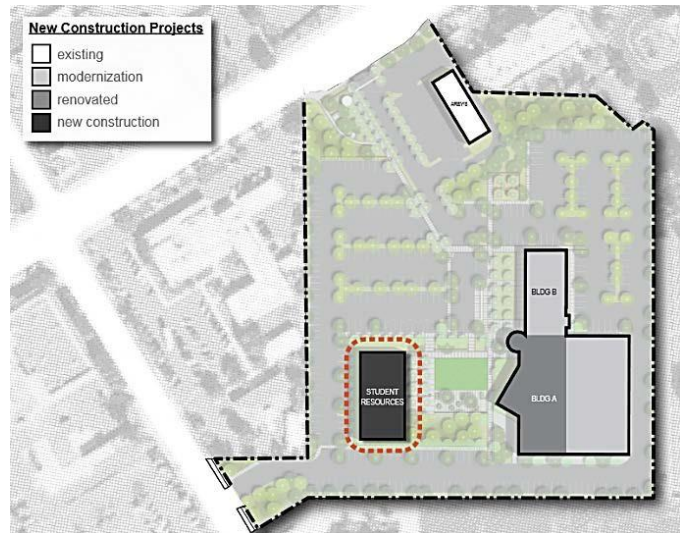

Example: Bioswale



Example: California Native Garden and Bioswale

DEMOLITION AND SITE PROJECTS

The demolition projects at the CLC look to remove the Small Business Development Center (SBDC) due to its critically poor condition and state of vacancy. Following the demolition of the outdated SBDC, the project will include the construction of new monument signage for the campus.

Project Timeframe:

- Design Start: August 2018
- Construction Start: March 2019
- Construction Completion: August 2019